

6+

# WOODEN KENDAMA



> GEOM <

## INSTRUCTIONS MANUAL



#23161 - 23162 - 23163 - 23164

  
SVoORA®

# KNOW YOUR KENDAMA



**KENSAKI**

Spike

**KOZARA**

Small Cup

**SARADO**

Cup Body

**OZARA**

Big Cup

**ITO**

String

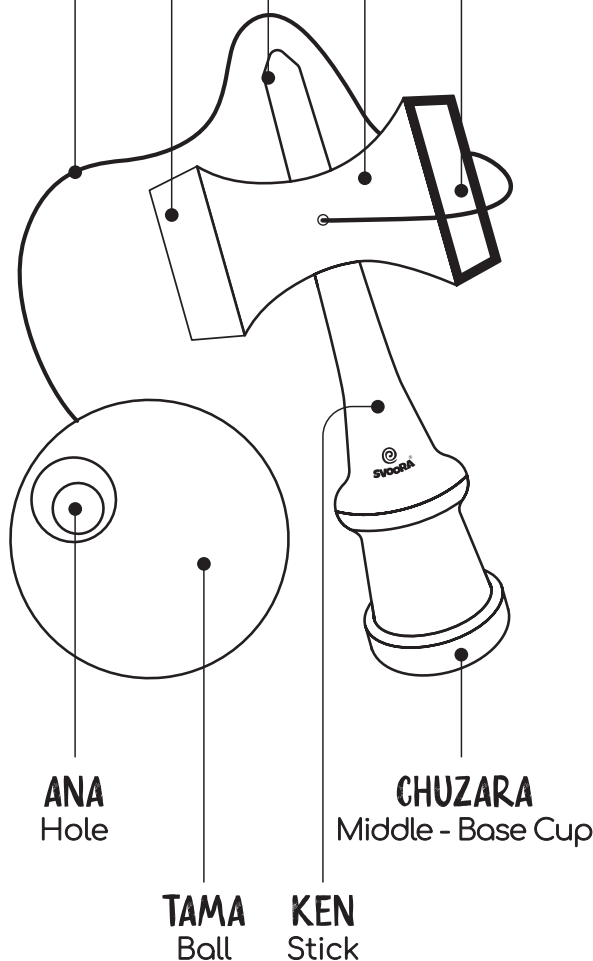

**ANA**

Hole

**CHUZARA**

Middle - Base Cup

**TAMA**

Ball

**KEN**

Stick

# HOW TO PLAY

## > BASIC TRICKS <

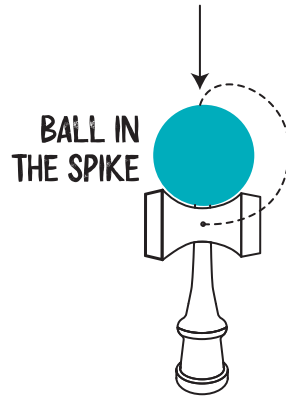
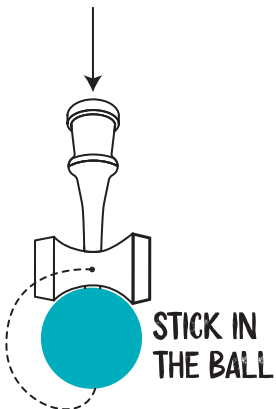
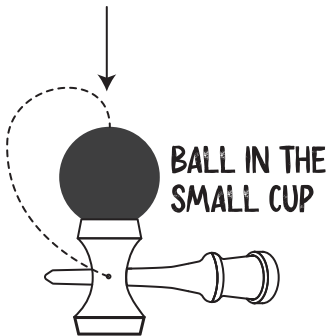
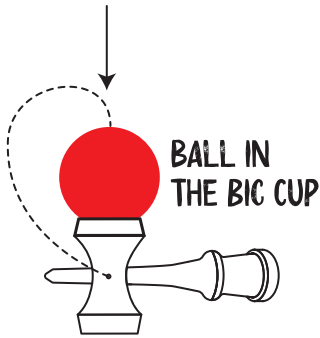

# KNOW THE STRING

## > HOW TO TIE <



1

**1.** The thickness of the string should be 1mm, the length should be around “4 fingers”, as seen in the image and the advisable material in ‘Nylon’.

**2.** There are 2 knots in the string: one passing through the wooden ball and ball bearing and one passing through the centre of the wooden handle.



2



3

**3.** Tie a knot, leaving about 1.5cm loose edge on the end of the rope.



4

**4.** The end loose of the rope must be inserted in the hole.



5

**5.** Pull the string from the other side, so that the knot is stable and secured.